

REV.	DESCRIPTION	DATE	DRAFTER	APPROVER
A1	DWG.REL	2020.6.02	ZHANG	JIN

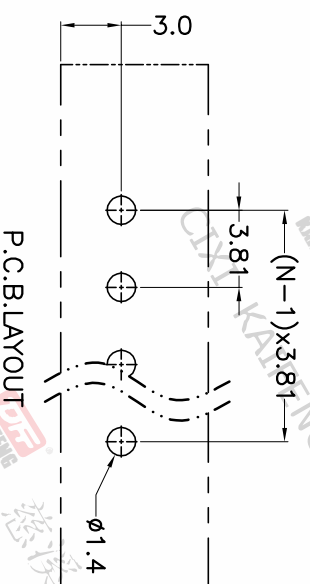
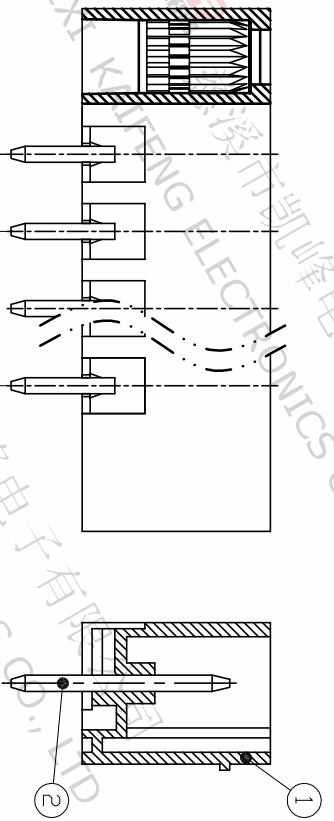
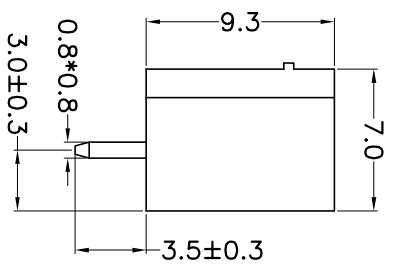
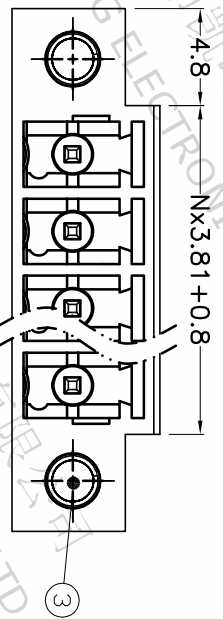

- Material  
 ① Housing : PA66, UL94V-0  
 ② Pin header : Copper alloy, Tin plated  
 ③ Nut : M2.5, Copper alloy

- Electrical  
 UL IEC  
 Rated voltage : 300V 250V  
 Rated current : 8A 7A  
 Contact resistance : 20mΩ(Max)  
 Insulation resistance: 500MΩ/DC500V  
 Withstanding Voltage : AC1500V/1min

- Mechanical  
 Operating temperature: -40°C ~ +105°C  
 Soldering temperature: 250°C ± 5 / 5sec

- RoHS compliance

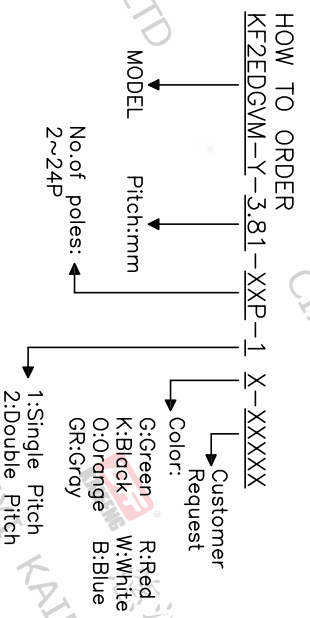

Pitch range	Nominal dimension range	PROJECTION	UNIT
>0	>30	0.1/10	mm
>6	>100		
~	~		
10	24		
6	30		
±0.15	±0.20		
±0.30	±0.50		
±0.30	±0.70		
±1.00	±1.30		
±2*			

DRAWING TYPE	CUSTOMER DRAWING
SCALE	1:1
SHEET	1 OF 1
DRAWING NO.	W10000742

TITLE	SHEET SIZE	SERIES
KF2EDGVM-Y-3.81-XXP-1X	A4	KF2EDGVM-Y

**DF** 慈溪市凯峰电子有限公司  
 CIXI KAIFENG ELECTRONICS CO.,LTD